



# TIEMME

## RACCORDERIA GENERICA GENERIC FITTINGS

### Serie 1555N

**Raccordo dritto tre pezzi nichelato con O-RING**

Nickel-plated 3-pieces straight fitting with O-RING

La raccorderia generica Tiemme si adatta ad ogni tipo di impianto idraulico domestico e commerciale, applicazioni industriali ed agricole, impianti di riscaldamento, igienico sanitari e generalmente con ogni fluido non corrosivo.

The brass generic fittings are suitable for domestic and commercial plumbing, industrial, agricultural application and generally with every non aggressive fluid.

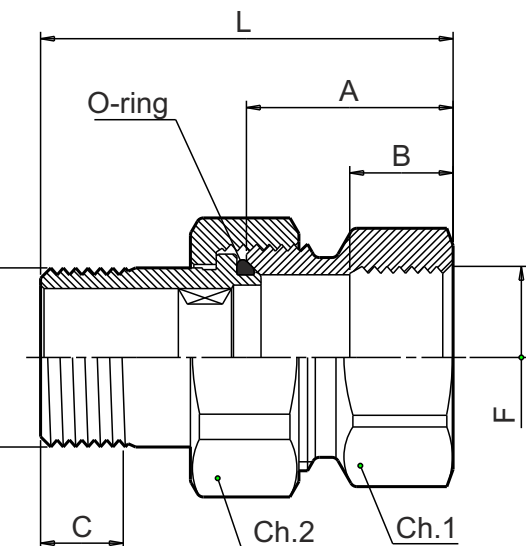
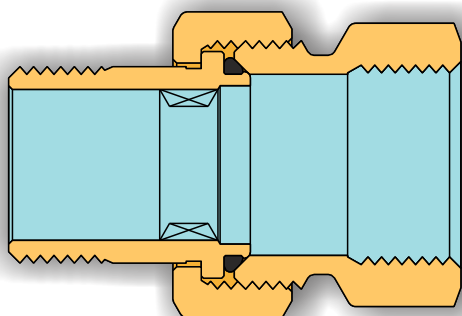

#### Caratteristiche Tecniche

Temperatura max di esercizio: 110°C  
 Temperatura min di esercizio: -20°C  
 Pressione max di esercizio: 30 bar  
 Filettature: femmina UNI ISO 228  
 maschio UNI ISO 228

#### Technical Features

Maximum temperature: 110°C  
 Minimum temperature: -20°C  
 Maximum operating pressure: 30 bar  
 Threads: female UNI ISO 228  
 male UNI ISO 228

#### Descrizione

Corpo: Ottone CW617N - En12165  
 Dado: Ottone CW617N - En12165  
 Codolo: Ottone CW617N - EN12165  
 O-ring: Gomma nitrilica NBR

#### Materiale

Ottone CW617N - En12165  
 Ottone CW617N - En12165  
 Ottone CW617N - EN12165  
 Gomma nitrilica NBR

#### Trattamento

Nichelatura  
 Nichelatura  
 Nichelatura  
 -

#### Description

Body: CW617N - EN12165 brass  
 Nut: CW617N - EN12165 brass  
 Tail: CW617N - EN12165 brass  
 O-ring: Nitrile rubber NBR

#### Material

CW617N - EN12165 brass  
 CW617N - EN12165 brass  
 CW617N - EN12165 brass  
 Nitrile rubber NBR

#### Treatment

Nickel-plated  
 Nickel-plated  
 Nickel-plated  
 -

#### Tabella dimensioni Sizes table

M	F	CODICE / CODE	L	A	B	C	Ch.1	Ch.2	O-ring
G 3/8"	G 3/8"	1555N000303	41	17	8	9	es.21	es.27	/ (*)
G 1/2"	G 1/2"	1555N000404	51,5	25	12,5	10	es.27	es.30	15,6x1,78
G 3/4"	G 3/4"	1555N000505	60	30	15	12	es.33	es.37	23,47x2,62
G 1"	G 1"	1555N000606	70	36,0	18	14	es.39	ott.46	29,82x2,62
G 1"1/4	G 1"1/4	1555N000707	77	39	21	15	ott.48	ott.52	36,17x2,62
G 1"1/2	G 1"1/2	1555N000808	88	49	23	17	ott.55	ott.66	42,52x2,62
G 2"	G 2"	1555N000909	109	56	25	18	ott.67	ott.80	55,25x2,62

(\*) guarnizione piana  
flat washer



TIEMME Raccorderie S.p.A.  
 Via Cavallera 6/A (Loc. Barco) - 25045 Castegnato (Bs) - Italy  
 Tel +39 030 2142211 R.A. - Fax +39 030 2142206  
 info@tiemme.com - www.tiemme.com

