



TIEMME

BALL VALVE FOR GAS

Art. 2223G

EN10226 (UNI EN ISO 7/1).

Standard bore ball valves with male/male threaded ends as per EN10226 (UNI EN ISO 7/1).

Available with yellow painted aluminum "T" handle.

2223

EN331.

The Art. 2223 valves are manufactured in accordance with the European standard EN331. They can be properly used for natural, domestic and liquid gas distribution. Also suitable for domestic and commercial plumbing, industrial and agricultural applications, heating and sanitary systems, pneumatic systems, oils, generally with every non-aggressive fluids. (Not suitable for methylic alcohol and saturated steam).

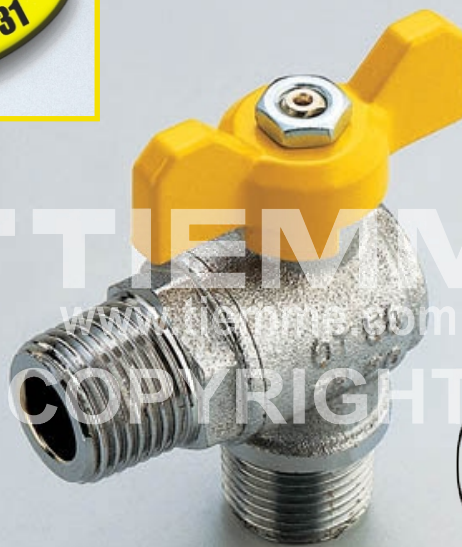

/ For complete range see catalogue



/ Certifications

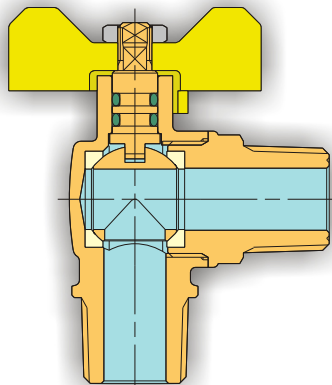

Technical Features

Maximum temperature:
Minimum temperature:
Operating pressure:
(working limits)
Threads:

60°C, 190°C
- 20°C
0 5 (MOP 5)
EN10226 (ISO 7/1 R)

with gas 60°C, other uses 190°C
- 20°C
with gas from 0 up to 5 bar (MOP 5)
other uses see diagram
male EN10226 (ISO 7/1 R) conical

CW617N - EN12165
CW614N - EN12164
CW614N - EN12164
(VITON)
1-

Description

Body
Ball
Stem
O-rings
Side washers
Handle
Nut

Material

CW617N - EN12165 brass
CW614N - EN12164 brass
CW614N - EN12164 brass
Fluorined rubber (VITON)
P.T.F.E. - 1st transformation
Aluminium
Steel

Treatment

Nickel plated
Chromium plated
-
-
-
Painted
Zinc plated



TIEMME Raccorderie S.p.A.
Via Cavallera 6/A (Loc. Barco) - 25045 Castegnato (Bs) - Italy
Tel +39 030 2142211 R.A. - Fax +39 030 2142206
info@tiemme.com - www.tiemme.com
©TIEMME Raccorderie S.p.A. 2223G Rev. 0 Rus 11-09



TIEMME Raccorderie S.p.A. reserves the right to modify contents in any time without prior advise. TIEMME is forbidden any reproduction unless under TIEMME authorization





TIEMME

BALL VALVE FOR GAS

Art. 2223G

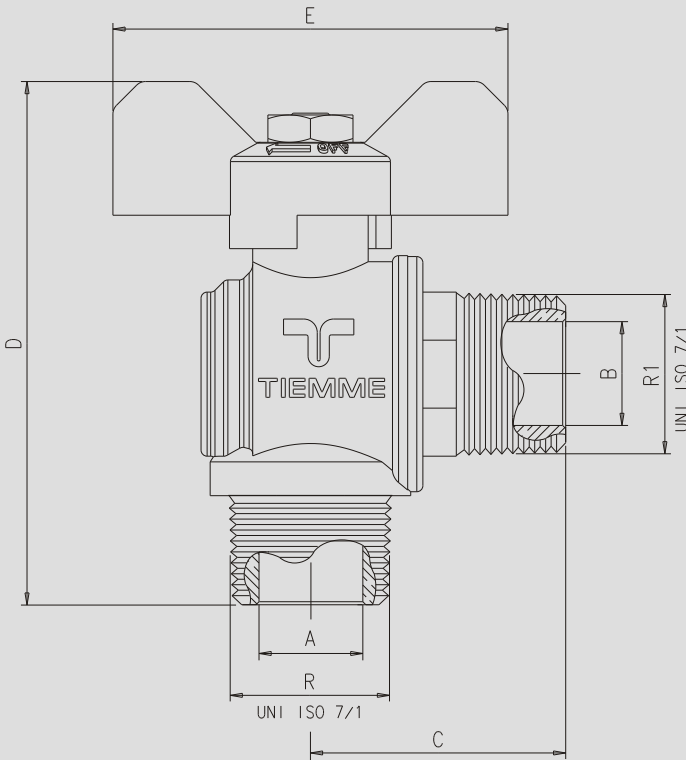

Sizes table

| | 2223G0704 | 2223G0705 |
|-----------|-----------|-----------|
| A | 12,0 | 19,0 |
| B | 12,0 | 19,0 |
| C | 38,5 | 42,0 |
| D | 74,5 | 86,2 |
| E | 50,0 | 65,0 |
| R | 1/2" | 3/4" |
| R1 | 1/2" | 3/4" |

Pressure / temperature diagram

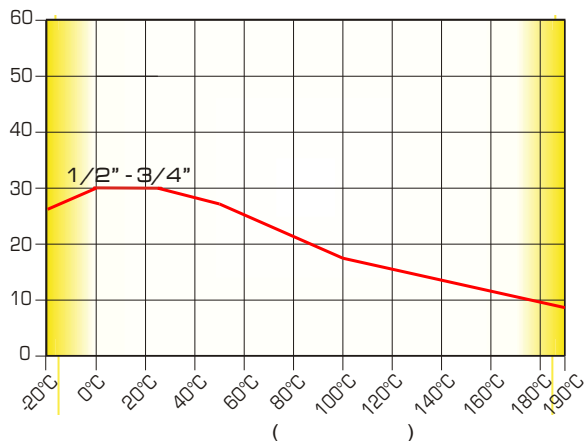

Flow / pressure drop diagram

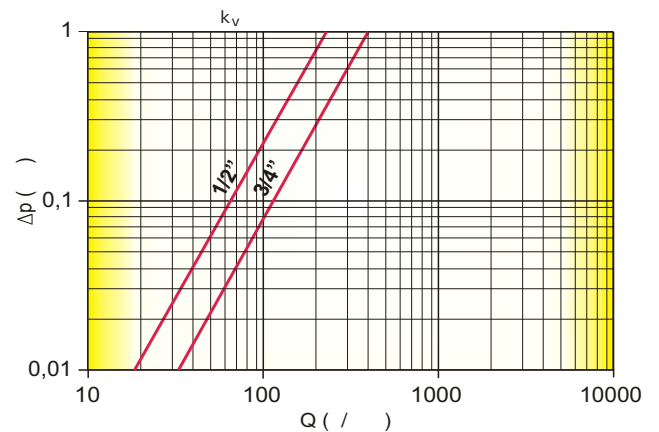

TIEMME Raccorderie S.p.A.
 Via Cavallera 6/A (Loc. Barco) - 25045 Castegnato (Bs) - Italy
 Tel +39 030 2142211 R.A. - Fax +39 030 2142206
 info@tiemme.com - www.tiemme.com

©TIEMME Raccorderie S.p.A. 2223G Rev. 0 Rus 11-09



TIEMME Raccorderie S.p.A.
 TIEMME Raccorderie S.p.A. reserves the right to modify contents many time without prior advise.
 TIEMME
 is forbidden any reproduction unless under TIEMME autorization





TIEMME

BALL VALVE FOR GAS

Art. 2223G

Installation instructions

(/ , ...)

(.).

“ ” /

Tiemme Raccorderie S.p.A.

Tiemme Raccorderie S.p.A.

TIEMME S.p.A.

The valves can be installed in any position (horizontal, vertical, ...) provided that shall be placed in visible and accessible position and the open/close operations shall be easily and completely done.

Otherwise stated to close the valve the handle shall be turned clockwise, counterclockwise to open it.

Otherwise stated by specific marks on the valve body (arrows,...) there is no valve flow direction.

The system shall be designed and realised in order to avoid any stress that could damage the valve and could compromise the sealing and the correct working of the valve.

All installation operations shall be done using properly tooling. The tightenings shall be such as to guarantee the sealing but without make any damage to the valve or fittings.

Once the installation have been completed is necessary to verify the sealings according to technical specifications and/or what required by the country of installation.

The valve should not be kept in intermediate position for a long period of time in order to avoid any damages of the valve sealings. If the valve have not been used for a long period of time it may be difficult to operate therefore it will be necessary to use a "long lever".

To kept the valve and sealings in good conditions it is suggested to place a filter upstream in order to stop impurity.

Tiemme Raccorderie S.p.A. decline any responsibility in case of damages and/or accidents when the installation is not done in conformity with technical and scientific rules in force and in conformity with manuals, catalogues and/or technical documentation written by Tiemme Raccorderie S.p.A.

For any further information please refer to your local dealer or directly to TIEMME S.p.A.



TIEMME Raccorderie S.p.A.
 Via Cavallera 6/A (Loc. Barco) - 25045 Castegnato (Bs) - Italy
 Tel +39 030 2142211 R.A. - Fax +39 030 2142206
 info@tiemme.com - www.tiemme.com

©TIEMME Raccorderie S.p.A. 2223G Rev. 0 Rus 11-09



TIEMME Raccorderie S.p.A. reserves the right to modify contents in any time without prior advise. TIEMME authorization is forbidden any reproduction unless under TIEMME authorization

