



# TIEMME

## VALVE FOR GAS APPLICATIONS

### Art. 2250G

ISO 7/1

PN4

UNI

Straight ball valves PN4 with female threaded end UNI ISO 7/1 and hose available with yellow handle.

Tiemme

The Tiemme ball valves can be properly used for natural, domestic and liquid gas distribution. They are suitable for domestic and commercial applications.

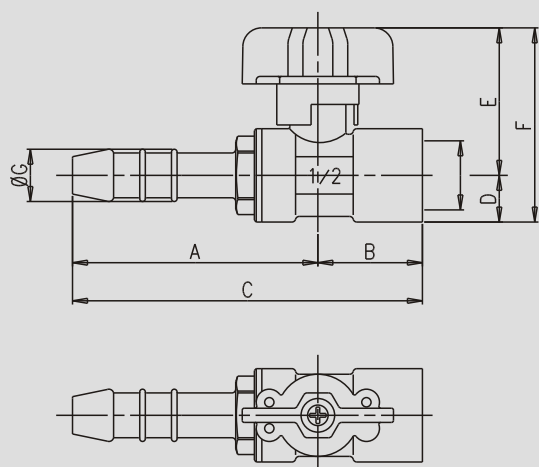

### Sizes table

		A	B	C	D	E	F	ØG
2250G1304	1/2"	65,0	28,5	93,5	12,5	39,5	52,0	13,0



/Certifications

: +120°C  
 : -20°C  
 : PN 4  
 : ISO 7/1 Rp

#### Technical Features

Maximum temperature: +120°C  
 Minimum temperature: -20°C  
 Operating pressure: PN 4 Bar  
 Threads: female ISO 7/1 Rp cylindrical

CW617N - EN12165  
 CW614N - EN12164  
 CW614N - EN12164  
 NBR

1- -

Description	Material	Treatment
Body	CW617N - EN12165 brass	Chromium plated
Ball	CW614N - EN12164 brass	Chromium plated
Stem	CW614N - EN12164 brass	Nickel plated
O-rings	Nitrile rubber NBR	-
Side washers	P.T.F.E. - 1 <sup>st</sup> transformation	-
Handle	Aluminium	Painted
Nut	Steel	Zincplated



**TIEMME Raccorderie S.p.A.**  
 Via Cavallera 6/A (Loc. Barco) - 25045 Castegnato (Bs) - Italy  
 Tel +39 030 2142211 R.A. - Fax +39 030 2142206  
 info@tiemme.com - www.tiemme.com





# TIEMME

## VALVE FOR GAS APPLICATIONS

## Art. 2250G

### Installation instructions

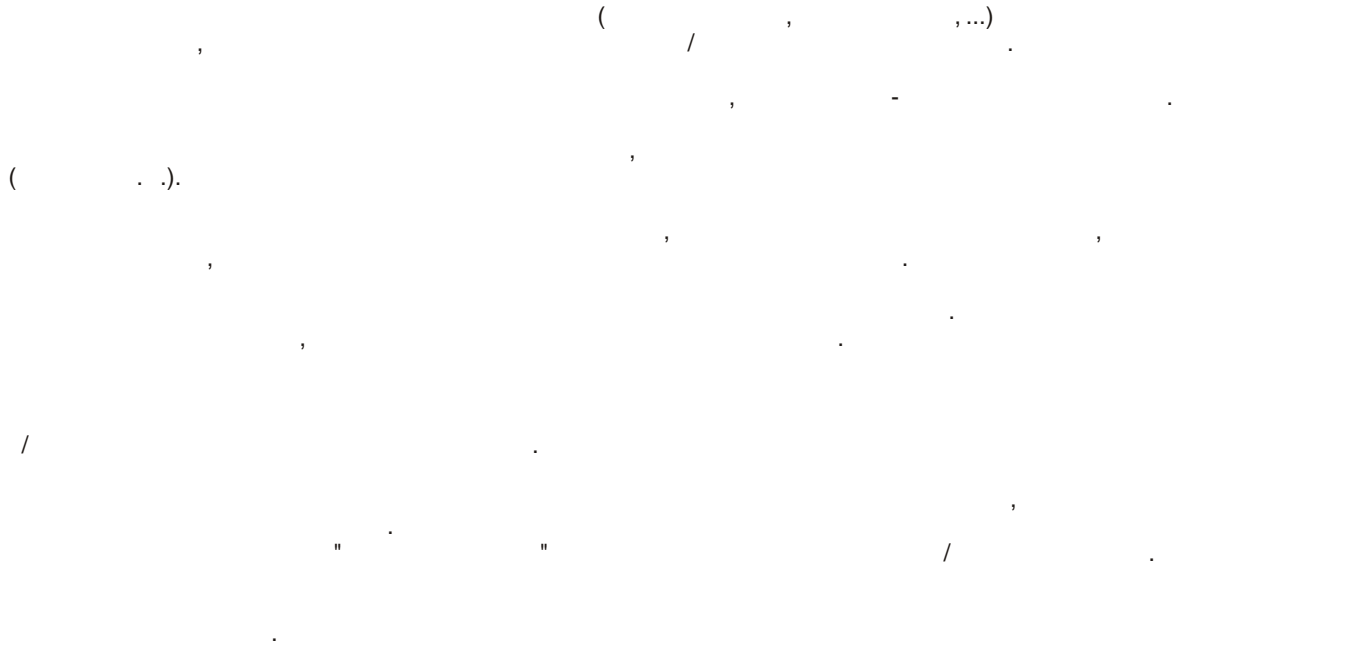

Tiemme Raccorderie S.p.A.

Tiemme Raccorderie S.p.A.

TIEMME S.p.A.

*The valves can be installed in any position (horizontal, vertical, ...) provided that shall be placed in visible and accessible position and the open/close operations shall be easily and completely done.*

*Otherwise stated to close the valve the handle shall be turned clockwise, counterclockwise to open it.*

*Otherwise stated by specific marks on the valve body (arrows,...) there is no valve flow direction.*

*The system shall be designed and realised in order to avoid any stress that could damage the valve and could compromise the sealing and the correct working of the valve.*

*All installation operations shall be done using properly tooling. The tightenings shall be such as to guarantee the sealing but without make any damage to the valve or fittings.*

*Once the installation have been completed is necessary to verify the sealings according to technical specifications and/or what required by the country of installation.*

*The valve should not be kept in intermediate position for a long period of time in order to avoid any damages of the valve sealings.*

*If the valve have not been used for a long period of time it may be difficult to operate therefore it will be necessary to use a "long lever".*

*To kept the valve and sealings in good conditions it is suggested to place a filter upstream in order to stop impurity.*

*Tiemme Raccorderie SpA decline any responsibility in case of damages and/or accidents when the installation is not done in conformity with technical and scientific rules in force and in conformity with manuals, catalogues and/or technical documentation written by Tiemme Raccorderie SpA.*

*For any further information please refer to your local dealer or directly to TIEMME S.p.A.*

TIEMME Raccorderie S.p.A. reserves the right to modify contents in any time without prior advise.  
TIEMME authorization is forbidden any reproduction unless under TIEMME authorization



**TIEMME Raccorderie S.p.A.**  
Via Cavallera 6/A (Loc. Barco) - 25045 Castegnato (Bs) - Italy  
Tel +39 030 2142211 R.A. - Fax +39 030 2142206  
info@tiemme.com - www.tiemme.com

